



NEWS RELEASE

April 7, 2026
Yamato Transport Co., Ltd.

Yamato Group Opens One of Its Largest Integrated Business Solutions Bases in Koto-ku, Tokyo, Close to the City Center

Yamato Transport Co., Ltd. (Headquarters: Chuo-ku, Tokyo; Representative Director and President: Seiichi Awa) announces that it has opened an integrated business solutions base in the Shinonome area of Tokyo's Koto-ku on April 7, 2026. This base combines the functions of sorting and transportation/delivery bound for the Yamato Group's logistics bases nationwide with logistics functions; operations will be launched sequentially for these functions beginning in June 2026.

The new base is a six-story logistics facility with one of the largest floor areas of the Yamato Group, following Haneda Chronogate in Ota-ku, Tokyo. In a floor space of approximately 59,500 square meters for providing logistics services, a bonded area^{*1} is to be established, in addition to a temperature and humidity-controlled area. Yamato Transport aims to further expand its corporate business by helping to achieve total optimization for its customers' supply chains and supporting their business strategies, utilizing this newly-established base.



■ Features of the New Base

The new base provides logistics solutions, integrating sorting, transportation, and logistics functions for the Yamato Group's logistics hubs nationwide. It will contribute to optimizing the entire supply chain and

business strategies of corporate customers by leveraging its highly convenient location close to central Tokyo, suitable for both domestic and international transportation and delivery, as well as the Yamato Group's environmentally friendly facilities, and a nationwide transportation, delivery, and warehousing network.

1. Providing High Value-added Logistics Services

The new base will provide logistics services, including inventory management and distribution processing, in a warehouse of approximately 59,500 square meters. It will unlock same-day delivery to stores in the Tokyo metropolitan area and a later order cut-off for next-day delivery, contributing to shorter lead times for delivery and maximizing sales opportunities for corporate customers. Furthermore, since there is no need for transportation and transfer of goods from inventory storage warehouses to transportation/distribution centers, the base contributes to improved transportation quality and reduced greenhouse gas emissions. Additionally, the base can handle products that require high quality to be maintained in its temperature- and humidity-controlled area. Furthermore, the bonded area^{*1} provides international logistics services such as storing and packing goods for import and export.

2. Ideal Location for Domestic and International Transportation and Delivery

The base is located approximately 1.5 km from the Toyosu Interchange on the Metropolitan Expressway Harumi Route, and within a five-kilometer radius of the Ginza and Nihonbashi areas in central Tokyo. Furthermore, it is about a 20-minute drive to the Oi Container Terminal, the core of Tokyo Port, and Tokyo International Airport (Haneda Airport), making it highly convenient for all modes of transport—land, sea, and air—and an excellent location as a hub for international transport.



3. Eco-friendly Design

- The base's power needs are met by electricity derived from renewable energy through the use of solar power generation equipment and batteries. This helps corporate customers reduce their Scope 3² greenhouse gas emissions.

■ Creating a Facilitative Working Environment and Showing Consideration for the Surrounding Community

On the top floor, employees have access to a lounge for lunch and breaks, part of efforts to create a facilitative working environment. In addition, a childcare facility is provided to ensure that employees who want to balance their careers and parenting can work with peace of mind. Furthermore, by enclosing the roads and rampways with noise barriers, not only is noise reduced from vehicles, but lighting is also mitigated from vehicles at night in consideration of the surrounding community.

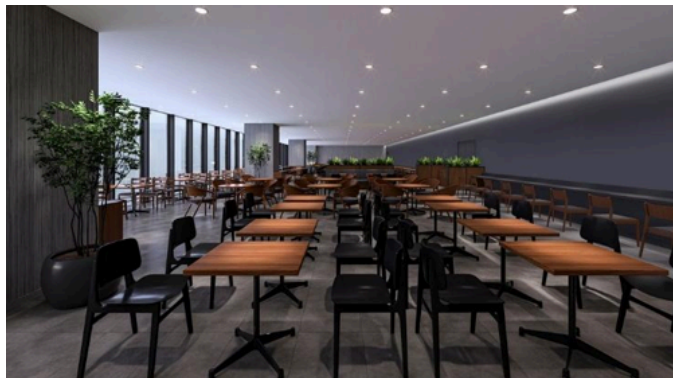

Lounge



Childcare facility

| | |
|-----------------|--|
| Floor area | 119,606.90 m ² |
| Location | 1-7-30 Shinonome, Koto-ku, Tokyo |
| Main facilities | Childcare facility, cafeteria, break room, lounge (with a 24-hour unmanned convenience store), solar power generation facilities (to be installed in July 2026), storage batteries, emergency generator, electric vehicle chargers |

■ Value Provided by Leveraging Yamato Group's Integrated Business Solutions Base

Based on the Yamato Group Medium-Term Management Plan "Sustainability Transformation 2030 ~1st Stage~, " the Group has identified the Contract Logistics Business as a growth area. Here, we are working to build a sustainable supply chain as a strategic partner, working alongside our customers to solve their business challenges. The foundation for this is the Yamato Group's integrated business solutions base, which brings together all of the Group's high-value-added functions. In the future, we will expand our integrated business solution bases to the Kansai, Chugoku, and Tohoku regions, providing new value to our customers and communities and helping to bring about a prosperous society.

*1 Bonded warehouse permit to be obtained by the end of FY2026

*2 GHG emissions in the supply chain indirectly emitted by other companies in relation to the company's own business activities

Contact

For corporate stakeholders:

Contract Logistics Department, Yamato Transport Co., Ltd.

Contact form: <https://business.kuronekoyamato.co.jp/contact/form/>

Press inquiries:

Corporate Communications, Yamato Transport Co., Ltd.

TEL: +81-3-3541-4141

Reference

Press releases:

Daiwa House Industry Co., Ltd.: Completion of Our Largest Urban Logistics Facility in Tokyo, DPL Tokyo Shinonome (April 7, 2026)

URL : <https://www.daiwahouse.co.jp/about/release/house/20260406124509.html>

Daiwa House Industry Co., Ltd.: Construction Starts on Large Multi-tenant Logistics Facility, DPL Shinonome (Tentative Name) (January 16, 2024)

URL : <https://prtimes.jp/main/html/rd/p/000002043.000002296.html>

Yamato Transport Co., Ltd.: Yamato Group to Open the Largest Integrated Business Solutions Base in the Tohoku Region (October 20, 2025)

URL : https://www.yamato-hd.co.jp/english/news/2025/pdf/newsrelease_20251020_en01.pdf